



# 752 Series

## 230VAC (Rail) LED PSU



*Long Life Reliability  
does not cost the earth*

### Feature Summary

- Two 325mA Constant Current outputs or One 650mA Constant Current Output.
- Ultra-high reliability design — 350,000 hours MTBF\*
- Simultaneous dimming of LED outputs
- Input to output isolation.
- Capable of driving up to 24 LEDs†.



### Product Codes

- The 752 Series Power Supplies are available in the following models:-  
752112 - Dual Output Dimmable  
752114 - Dual Output Non-Dimmable

Product Range Standard Features	
<b>Input Voltage Range</b>	160-265VAC
<b>Enclosure Type</b>	IP65 Aluminium Exstrusion
<b>Input Connector</b>	6.3mm (0.25") Faston Blades
<b>Output Connector</b>	Flying Leads with Entrelec 6- Way MFI6 Connector

\* MTBF calculated using US MIL-217F GM standard @ 40°C.

† Assuming single 1W LEDs.



## Input Specification

<b>Acceptable Input Supply Voltage Range</b>	160-265VAC
<b>Input Voltage Limit Without Damage</b>	280VAC
<b>AC Input Current (max @ 230VAC)</b>	0.2A
<b>Quiescent Current (No Load @ 230VAC)</b>	60mA
<b>Peak Inrush Current (@ Peak Sine)</b>	60A
<b>Time to Half Value (@ T=25°C)</b>	350us

## Output Specification

### Two 325mA Outputs

<b>Maximum Output Current</b>	325mA
<b>Maximum Output Voltage</b>	50VDC
<b>Maximum LEDs (Per Output)</b>	12 x 1W
<b>Short Circuit Current</b>	325mA

### One 650mA Output (Outputs Paralleled)

<b>Maximum Output Current</b>	650mA
<b>Maximum Output Voltage</b>	50VDC
<b>Maximum LEDs (Per Output)</b>	12 x 2W
<b>Short Circuit Current</b>	650mA



## Environmental Specification

All Variants		
Unit Weight	460	g
Sealing Rating	IP65	
Operating Temperature Range	-30 to 55	°C
MTBF Ground Mobile 40°C	350,000	Hrs

## Compliance

The 752 Series Industrial LED Power Supplies comply with the following standards:

- EN50121-3-2 Rolling stock equipment. Electromagnetic compatibility.
- EN61373 Rolling stock equipment. Shock and vibration.
- EN50155 Electronic equipment used on rolling stock.

## Safety Specification

The 752 Series LED PSU is equipped with the following protection circuitry as standard:

- Input to output isolation.
- Output short circuit protection.
- Load inrush protection.
- Input and output transient protection.

## Installation Guide

### General Installation Notes:

The unit should be connected to the mains supply via a readily accessible disconnect device incorporated external to the equipment.  
 The unit contains no user serviceable parts.  
 The unit must be EARTHED  
 The unit should be installed in a restricted access location.

Maximum Supply Cable Impedance	
Input Voltage V AC	Impedance Ω*
160-265	2



Installation Diagrams

Two 325mA Outputs

One 650mA Output (Outputs Paralleled)

230VAC Mains Supply  
MUST BE EARTHED

230VAC Mains Supply  
MUST BE EARTHED

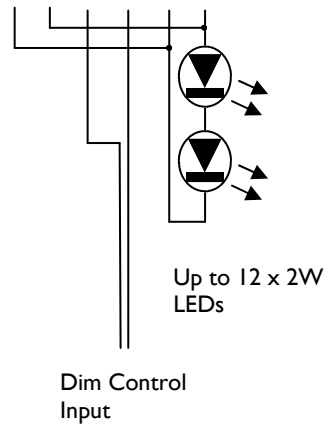
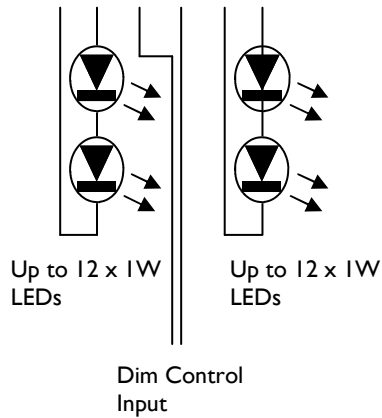
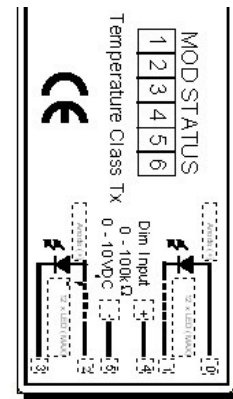
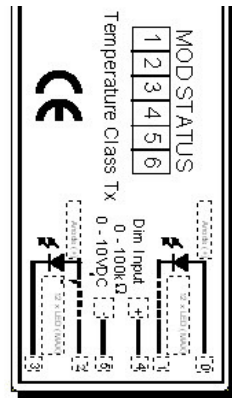

# Mechanical Specification

All Dimensions in mm unless stated otherwise

Figure 1 - Enclosure Details  
0.25" Faston Blades & Entrelec MF16 Connectors

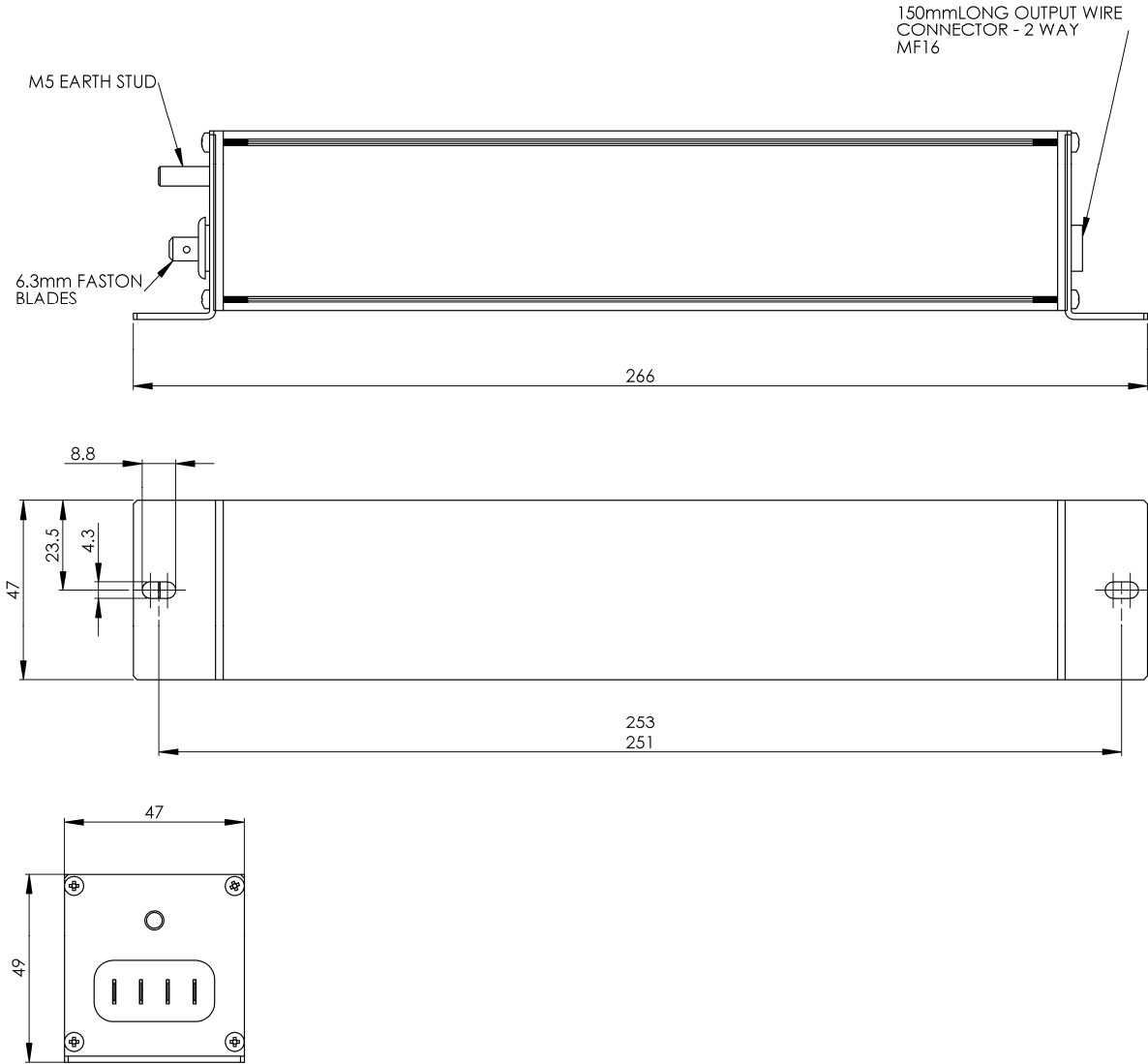

LPA-Excil makes every effort to ensure the accuracy of the information contained within this datasheet. However we reserve the right to withdraw and re-issue this datasheet at a later date.

© LPA-Excil Electronics, 2007



LPA-Excil Electronics  
 Ripley Drive, Normanton,  
 WF6 1QT, UK  
 Tel: +44 (0)1924 224100  
 Fax: +44 (0)1924 224111  
 Email: enquiries@lpa-excil.com

LPA Excil Electronics is a member of the LPA group